

IPF SPORT WIRING SYSTEM Installation Manual

BP070-510BD1-A

Model No. : WF-1DT

Thank you very much for purchasing IPF product.
Please read thoroughly this entire manual and use the product correctly.
Please keep and do not lose this manual even after you read and installed the product.
The ⚠ CAUTION and ⚠ WARNING marks indicated in this manual are cautionary points related to the installation of the product.
Therefore, please follow and observe strictly these points.

⚠ CAUTION

This wiring harness is intended to use for IPF brand products only.

Please read the installation procedures thoroughly beforehand.

- The Switch / Relay / Fuse box are NOT waterproofed. Please be installed in a position where the water is not applied.
- Please ensure whether this wiring harness will be adaptable to the vehicle or not.
- Before installation procedures, please make sure the electrical components of the vehicle are operating normally. (Please record and save the memorized setting of electrical components.)

Precautions for Safety Use ⚠ CAUTION

- This product is dedicated to DC 12V. (Please purchase 24V Relay sold optionally if you use this for DC 24V vehicle. In that case, please check the corresponding voltage of product that will be connected to this.)
- Installation of this product should be done by pro-mechanics at stores or dealers that have technical skills of electronics.
- All work procedures should be carried out on the flat ground, turn off the engine and set the parking brake.
- All the connectors and terminals should be solidly connected.
- Do NOT modify or disassemble this product in any way.
- After installing the lamp, please periodically tighten the bolts and nuts.
- After installation, please make sure all the electrical components of the vehicle are operating normally. (Please reset to the original setting.)
- Wear rubber gloves during the installation procedure.
- Make sure the engine compartment is adequately cool before starting work.
- Pierce a $\phi 20\text{mm}$ hole in dashboard or switch hole cover and install the switch. Please be careful not to damage the other components of the vehicle.

Complete parts

①

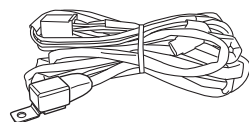

No.	Parts Name	No. of pcs
①	Wiring harness (Including; 12V Relay / Switch / Fuse box)	1

Wiring harness Installation Sequence

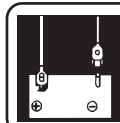

Before the installation work, you must remove the (-) terminal of the battery. If the vehicle mounts 2 batteries, remove both (-) terminals.



Install the relay and harness in a position where it will not make contact with high temperature surface. (Such as engine, radiators, or supercharger, exhaust pipes.)



All the connectors and terminals should be solidly connected.



Do not pull strongly the harness and connectors.



Install the harness and cords in a position where it will not be scratched, bent or pressed such as in moving parts (Pedals / Wires / Doors / Belts / Pulleys). In some cases, it may cause the vehicle to catch fire.



Harness and cords should be securely tied by cable ties or tapes.

⚠ WARNING

Strictly follow the cautionary points mentioned above. Incorrect or faulty wiring may cause the vehicle to catch fire.

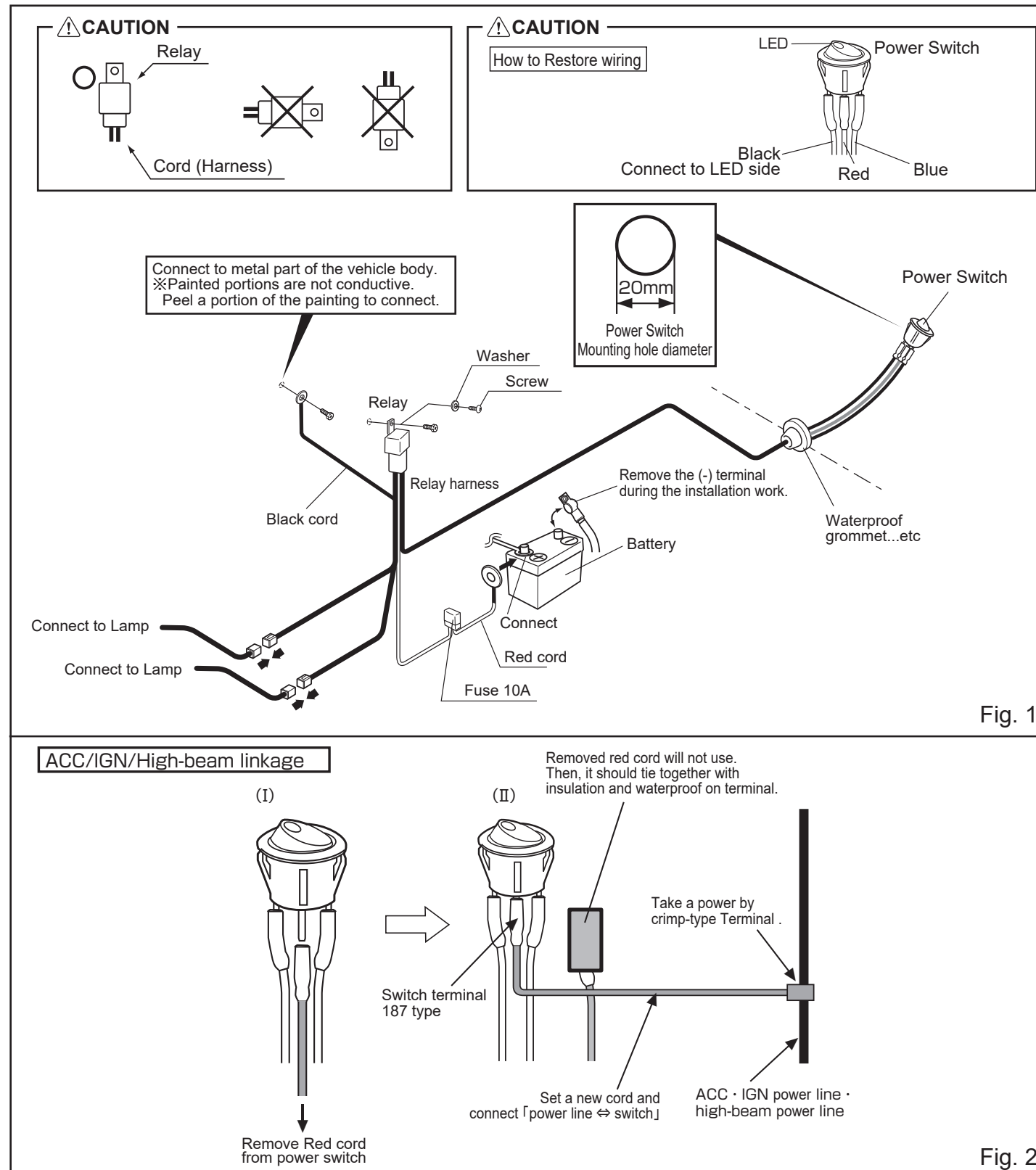

Fig. 1

Fig. 2

Check up after Installation Sequence



Please tighten securely bolts, nuts, and screws.

- ① Reconnect the battery's (-) terminal.
- ② Turn on the switch of the wiring system and make sure the lamp(s) is active.
- ③ Reset to the original setting of the electrical components such as audio.
- ④ Confirm all the electrical components such as headlamps, position lamps, and turn signals work properly.
- ⑤ In a position where the harness and cords will be vibrated, should be securely tied by cable ties or tapes.