



# Single-Row / Double-Row LED Light Bar 600 Series Installation Manual

PN : 611FJ/621FJ/641FJ  
612RJ/622RJ/642RJ/652RJ

## Component parts

### Single-row type (611FJ/621FJ/641FJ)

No.	Part name	No. of pcs	No.	Part name	No. of pcs
①	Lamp (2 nuts, 2 spring washers, 2 plain washers included)	1	⑤	Tamper-resistant button head bolt (M6 × 25)	2
②	Harness (relay, switch, fuse box included)	1	⑥	Washer (M6: black)	2
③	Brackets (for the single-row type: silver)	2	⑦	Washer (M6: silver)	2
④	L-shaped wrench	1			

### Double-row type (612RJ/622RJ/642RJ/652RJ)

No.	Part name	No. of pcs	No.	Part name	No. of pcs
⑧	Lamp [612RJ/622RJ] (Guard Emblem, guard assy, 2 nuts, 2 spring washers, 2 plain washers included)	1	⑨	Harness (relay, switch, fuse box included)	1
	Lamp [642RJ] (2 Guard Emblems, guard assy, 2 nuts, 2 spring washers, 2 plain washers included)		⑩	Brackets (for the double-row type: black)	2
	Lamp [652RJ] (3 Guard Emblems, guard assy, 2 nuts, 2 spring washers, 2 plain washers included)		⑪	Pipe holder (vibration dampener) [642RJ/652RJ]	2

## Specification

### Single-row type (611FJ/621FJ/641FJ)

PN	Inch	Power consumption	Fuse	Operating voltage	Operating temperature	Weight (brackets included)	
611FJ	10	12V	40W	10V~16V	-30°C~+75°C	1,200g	
621FJ	20		80W			15A	2,200g
641FJ	40		165W			20A	4,100g

### Double-row type (612RJ/622RJ/642RJ/652RJ)

PN	Inch	Power consumption	Fuse	Operating voltage	Operating temperature	Weight (brackets included)	
612RJ	10	12V	54W	10V~16V	-30°C~+75°C	1,650g	
622RJ	20		117W			15A	3,000g
642RJ	40		210W			20A	5,600g
652RJ	50		215W			30A	7,000g

## How to wire

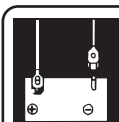

Before the installation work, you must remove the (-) terminal of the battery. If the vehicle mounts 2 batteries, remove both (-) terminals.



Install the relay and harness in a position where it will not make contact with high temperature surface. (Such as engine, radiators, or supercharger, exhaust pipes.)



All the connectors and terminals should be solidly connected.



Do not pull strongly the harness and connectors.



Install the harness and cords in a position where it will not be scratched, bent or pressed such as in moving parts (Pedals / Wires / Doors / Belts / Pulleys). In some cases, it may cause the vehicle to catch fire.



Harness and cords should be securely tied by cable ties or tapes.

1. Connect each component part as shown in the Fig. 1. Remove the wires from the switch if the switch harness passes through into the vehicle. Reconnect the wires to the switch. Refer to **How to connect** in the Fig. 1.

**⚠ WARNING**

**Strictly follow the cautionary points mentioned above. Incorrect or faulty wiring may cause the vehicle to catch fire.**

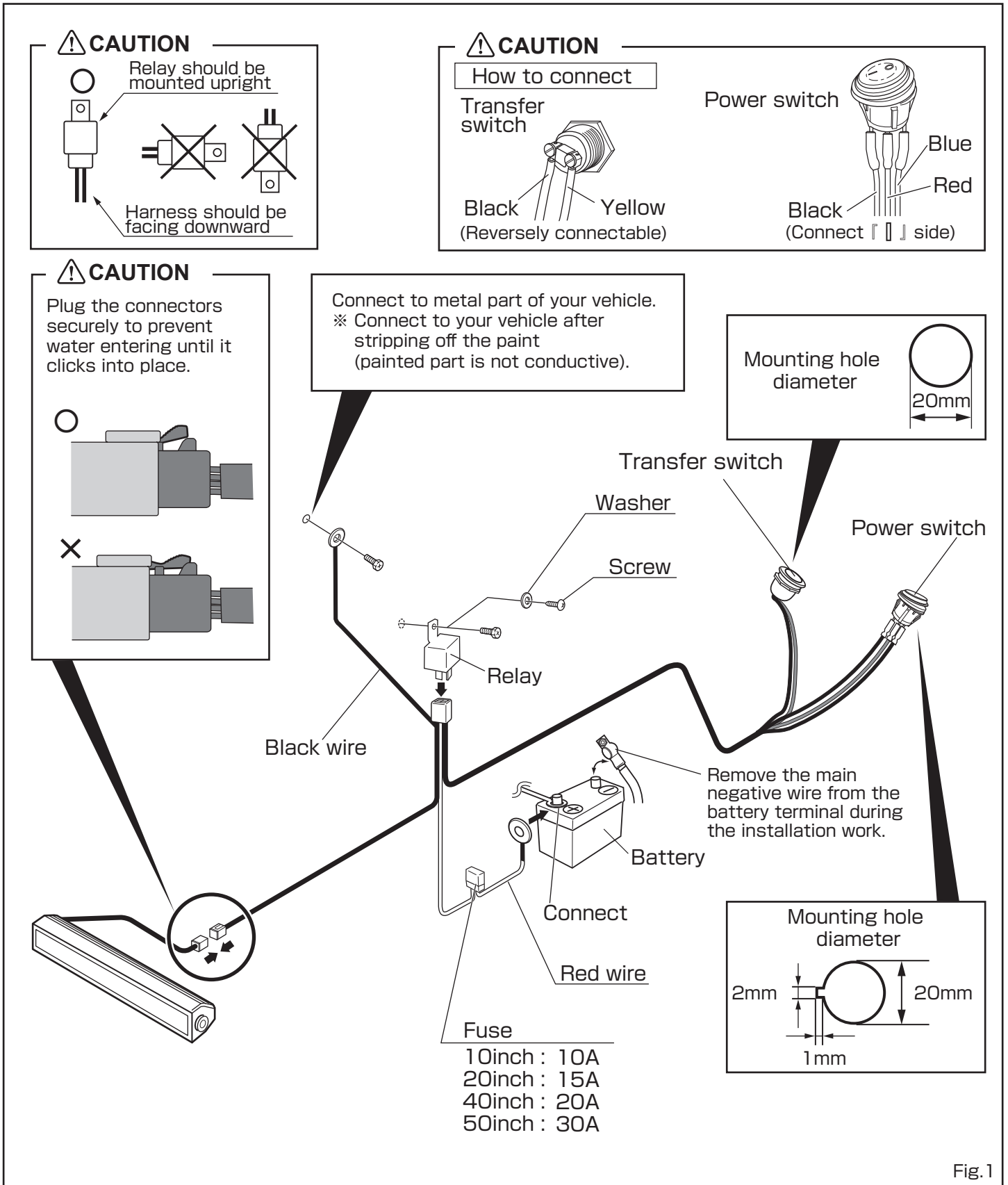

Fig.1

2. Connect the switch to the power wire of the vehicle headlamp high beam etc. Refer to the Fig. 2.

## Switch on and off with ACC or IGN or the vehicle headlamp HIGH BEAM

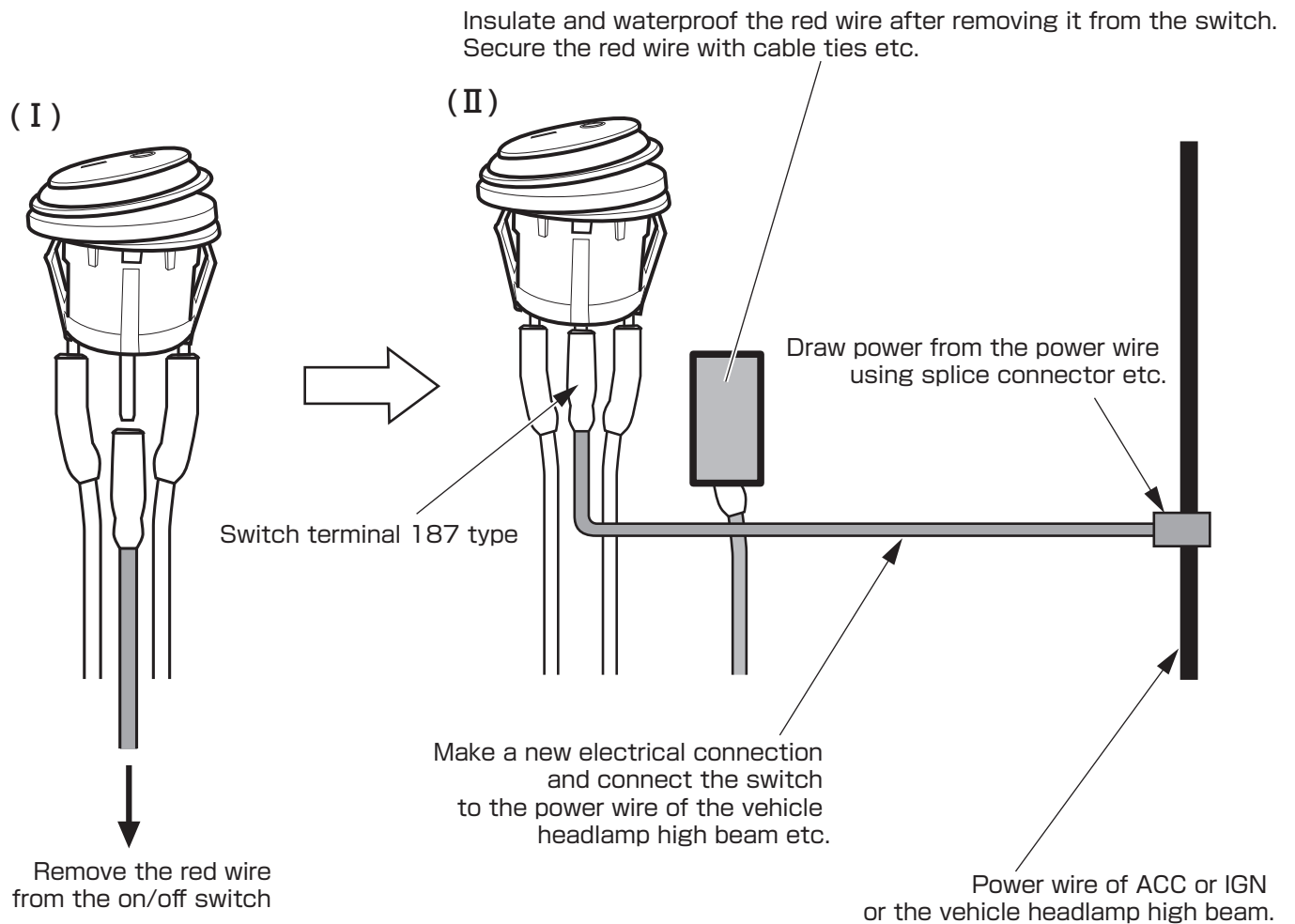
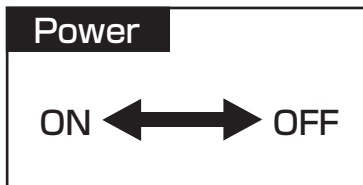
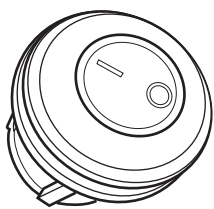
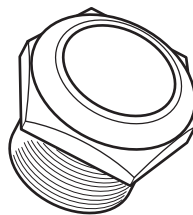

Fig.2

### Switch control procedure and lighting repetitive pattern



Power switch



#### Lighting repetitive pattern

Each time the switch pressed :

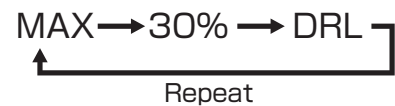

Transfer switch

#### ⚠ CAUTION

The lighting pattern when the light turned off is stored on the product.  
Default lighting pattern when you purchase this product is DRL mode.  
Press the transfer switch to confirm the lighting pattern can change accordingly.

## How to install brackets



Install with the nut and bolt where there is enough strength to support the bracket. Incorrect installment might result in the lamp falling off.



Confirm the bolt is tightened properly. Also, tighten the bolt with regular maintenance.

### Single-row type (611FJ/621FJ/641FJ)

This figure below indicates LH side (RH side is also in the same way). In addition, the numbers in the figure below indicate the component No.

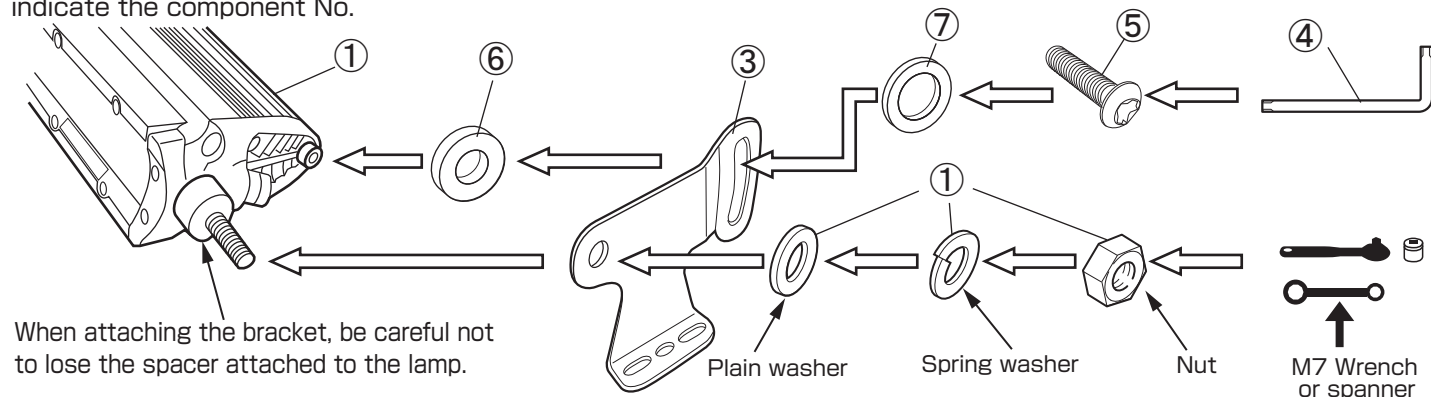

### How to adjust and secure lamp angle

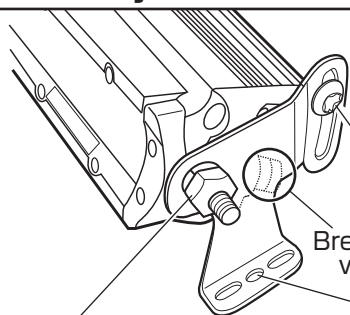

Adjustment of your lamp angle can be done by loosening these attachments, both sides of your lamp's bracket. Secure the attachments tightly so that your lamp does not incline by vibration.

#### CAUTION

The plug located at the side of your lamp is the breather valve with dust & waterproof function. Do not rotate the plug in any way.

( Tightening torque: 10N·m )

Secure your lamp with M6 bolt etc. to bracket's base holes.

### Double-row type (612RJ/622RJ/642RJ/652RJ)

This figure below indicates LH side (RH side is also in the same way). In addition, the numbers in the figure below indicate the component No. (Yellow spacers included in the package are not used for assembly.)

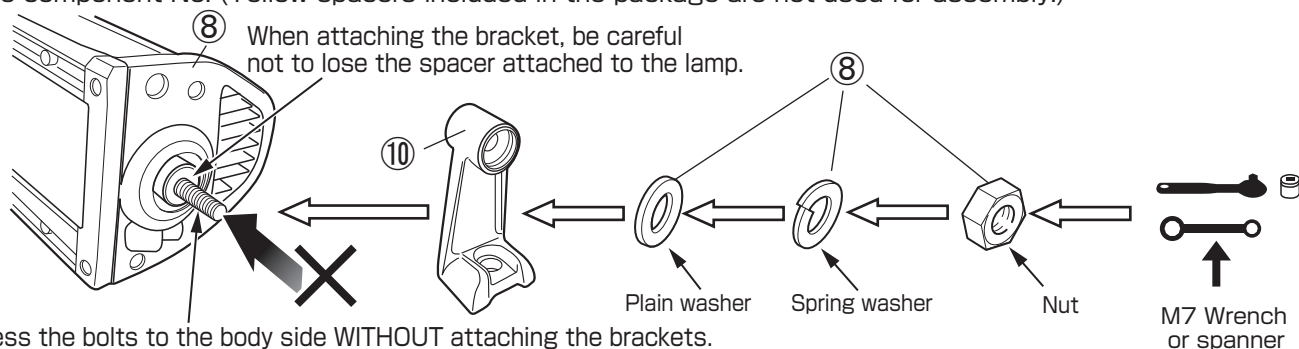

DO NOT press the bolts to the body side WITHOUT attaching the brackets. It causes damage to the waterproof performance.

### How to adjust and secure lamp angle

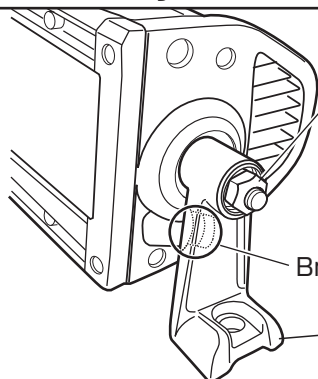

Adjustment of your lamp angle can be done by loosening this nut, both sides of your lamp's bracket. Secure the attachments tightly so that your lamp does not incline by vibration. ( Tightening torque: 10N·m )

#### CAUTION

The plug located at the side of your lamp is the breather valve with dust & waterproof function. Do not rotate the plug in any way.

Secure your lamp with M6 bolt etc. to bracket's base holes.

## How to remove & attach the Guard Emblem

If you install your lamp upside down (using the included harness in the opposite direction), follow below procedure to remove and reattach the Guard Emblem (double-row type only).

### How to remove the Guard Emblem

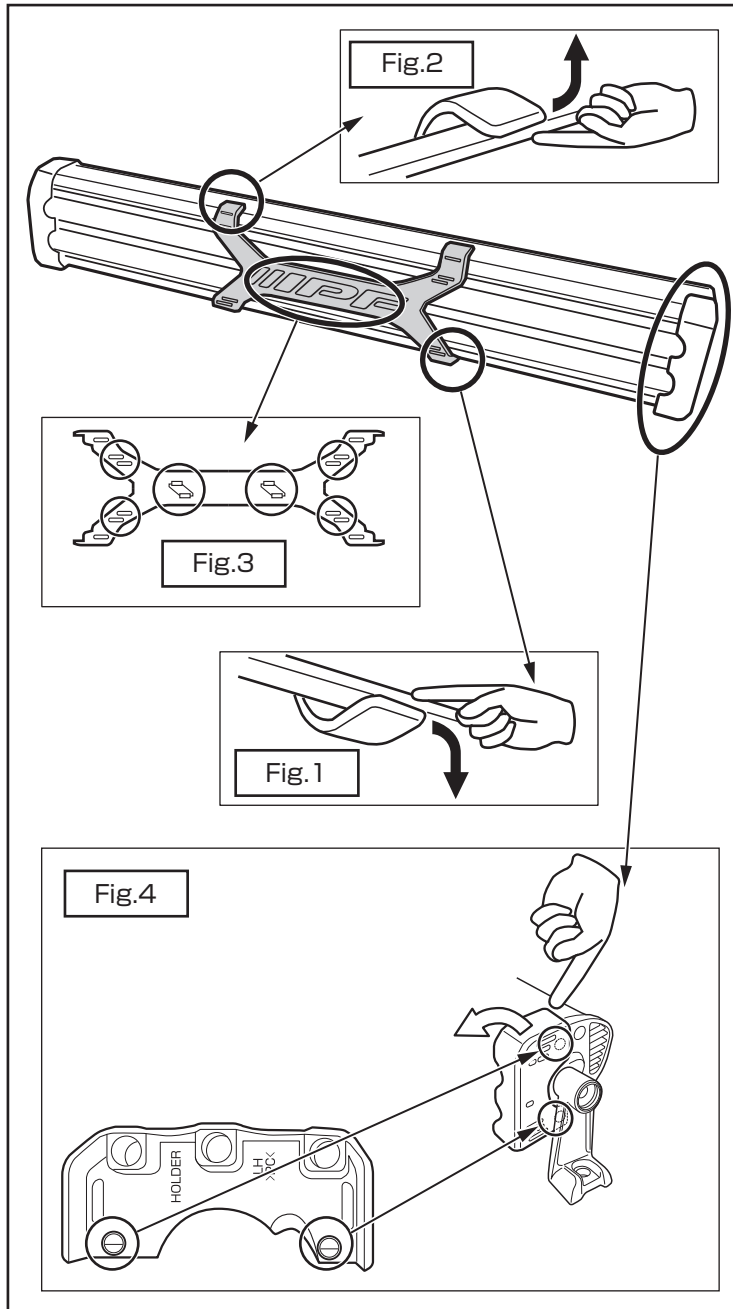

1. Remove downside tabs (Fig.1) from your lamp and backside lower tabs (Fig.3) from the guard pipe.

2. Remove upside tabs (Fig.2) from your lamp and backside upper tabs (Fig.3) from the guard assembly's pipe.

3. Remove backside mid tabs (Fig.3) from the guard assembly's pipe.

4. Lift the side holder and detach the bosses (Fig.4) while you remove the guard assembly from your lamp.

#### **CAUTION**

The guard assembly may be damaged if you pull it up forcibly. Carefully use an edge-protected tool if it's necessary to remove.

5. Pull out the guard assembly on an angle to the front side and remove.

### How to attach the Guard Emblem

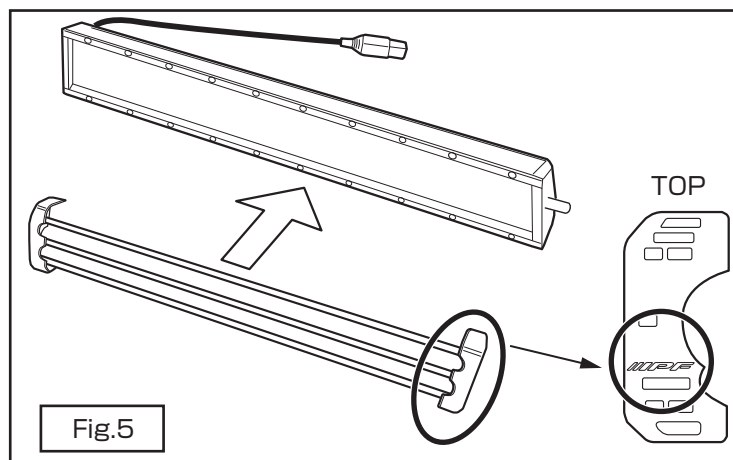

1. Attach the guard assembly to your lamp until it clicks into place.

#### **CAUTION**

The guard assembly will be damaged if you attach it upside down. Use IPF logo (Fig.5) as a reference.

2. Attach the Guard Emblem while you push backside tabs into the guard ASSY's pipes until it clicks into place (Fig.6).

**CAUTION**

The Guard Emblem may come off if the tabs are not fitted securely onto the guard ASSY's pipes or if the part of the Guard Emblem making contact with the bolts on your lamp (Fig.7). Check to see if the guard ASSY's pipes are in the right position, and reattach if it appears curved from the sideways view (Fig.8).

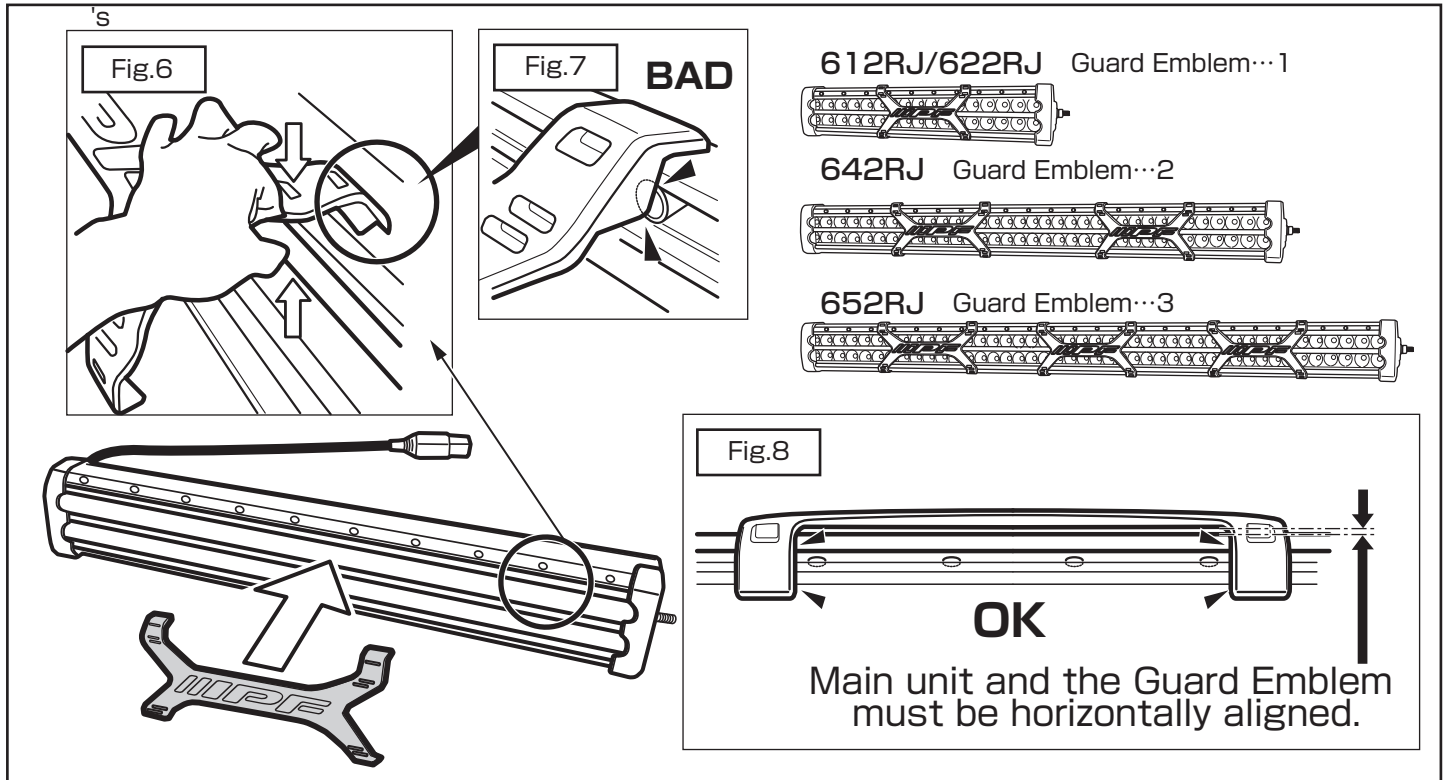

3. Use the pipe holders if you do not attach the Guard Emblems (for 642RJ & 652RJ only).

4. Attach the pipe holders to the guard assy's pipes as △-mark facing upward (Fig.9,10).

5. Push the pipe holder's □ part into your lamp in place (Fig.10).

**CAUTION**

Avoid the pipe holders making contact with the bolts (Fig.11).

6. Push the pipe holders into the heatsink ribs in place (Fig.12,13,14). Verify that the pipe holders are fitted securely.

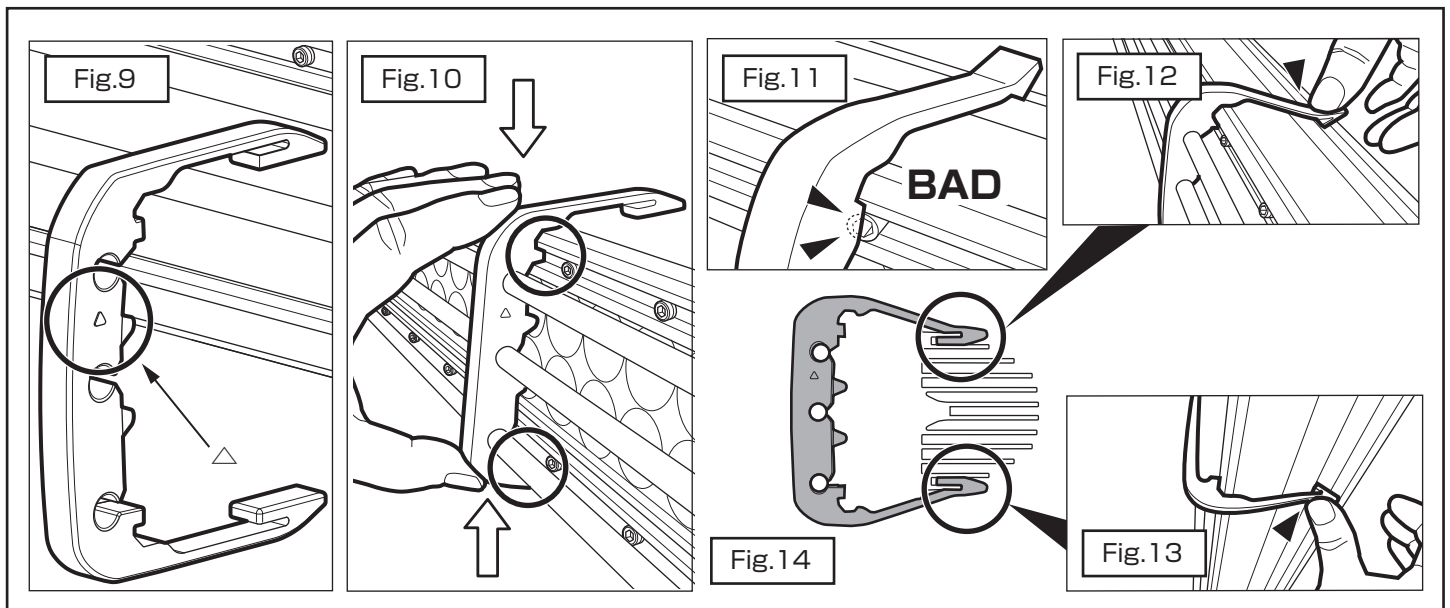

**Warranty**

This product is one year warranty.